

GENUINE FOODS AND EQUIPMENTS

(ISO 9001: 2015 CERTIFIED COMPANY)



REGD-OFFICE:

Senthil Nagar, Varadharajapuram, Chennai - 600 048.

WORKS:

No – 5/18 A, Kallangadu, Kadampadi, Sulur, Coimbatore - 641 401.

Mail- sales@genuineequipments.com.

Web www.Genuineequipments.com

Mob – 98400 73979, 78459 72789, 97894 07896

VIBRATING EQUIPMENTS

- **VIBRO SCREEN**
- **VIBRO DESTONER**
- **VIBRO MOTOR**
- **ELECTRO-MAGNETIC VIBRATORY FEEDER**
- **BIN ACTIVATOR**



VIBRO SCREEN

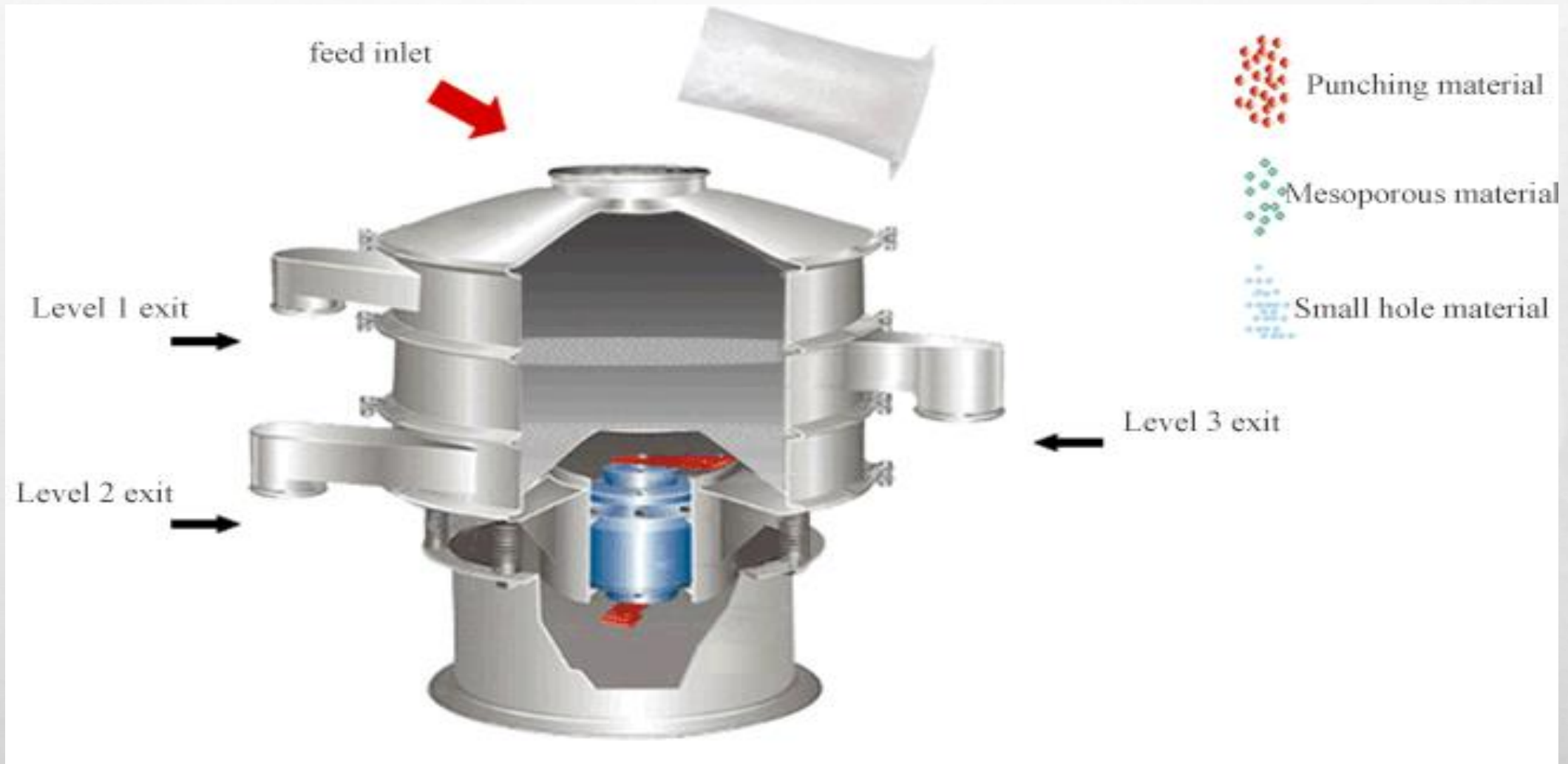

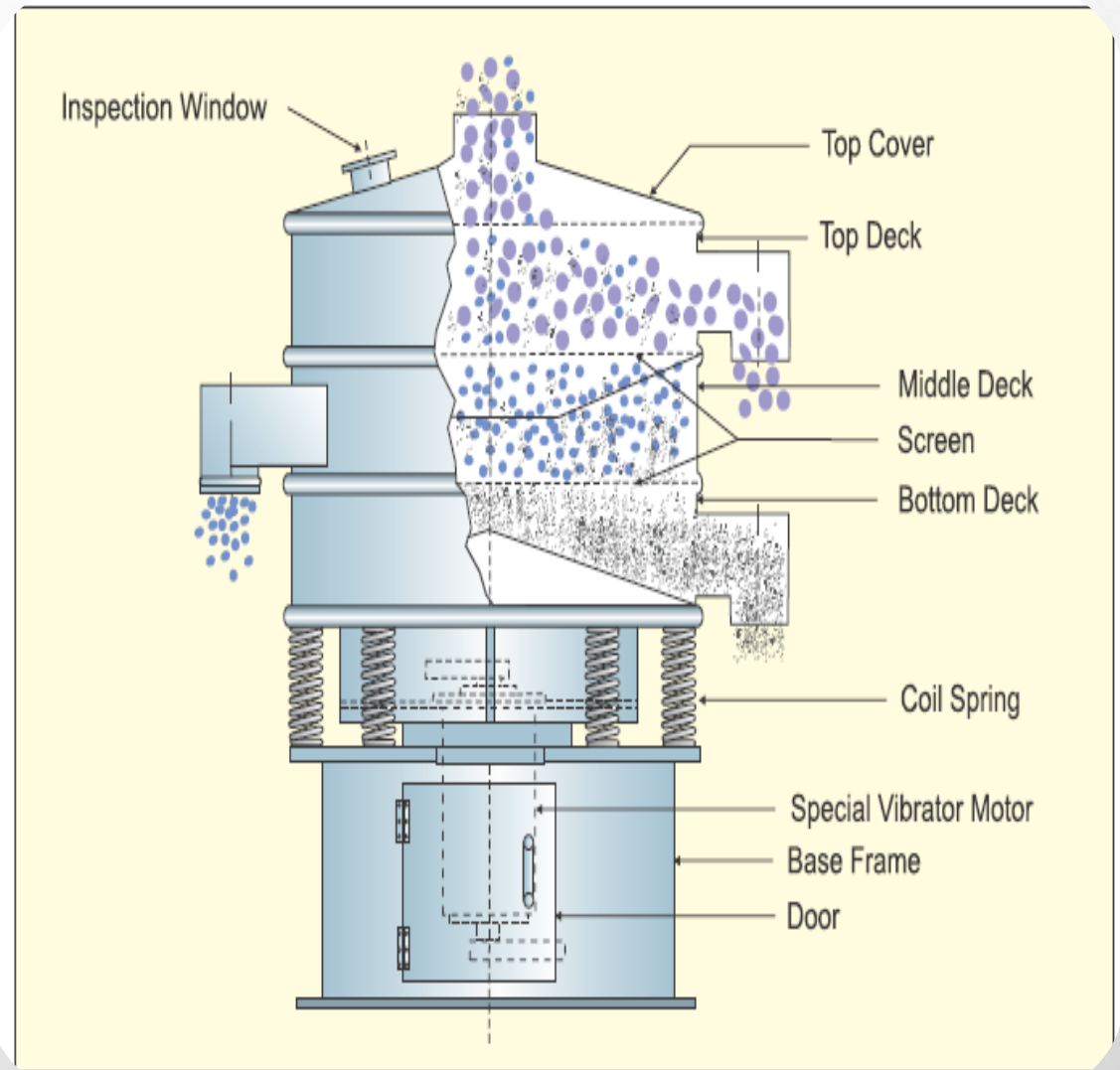



Screening Patterns :

Adjustment of top & bottom weights in accordance with the following diagrams

(Examples of screen patterns for average materials)

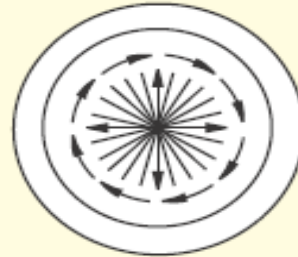

FIG-1 - 0° LEAD
Material Travels
Radially

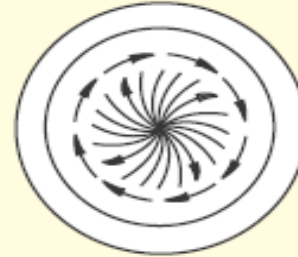

FIG-2 - 15° LEAD
Material Travels Takes
Longer Time

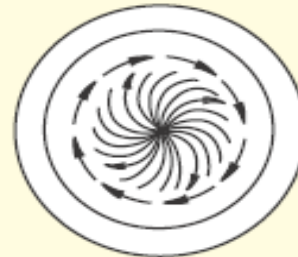

FIG-3 - 45° LEAD
Material Moves In
Spiral Design

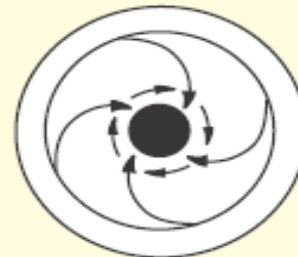
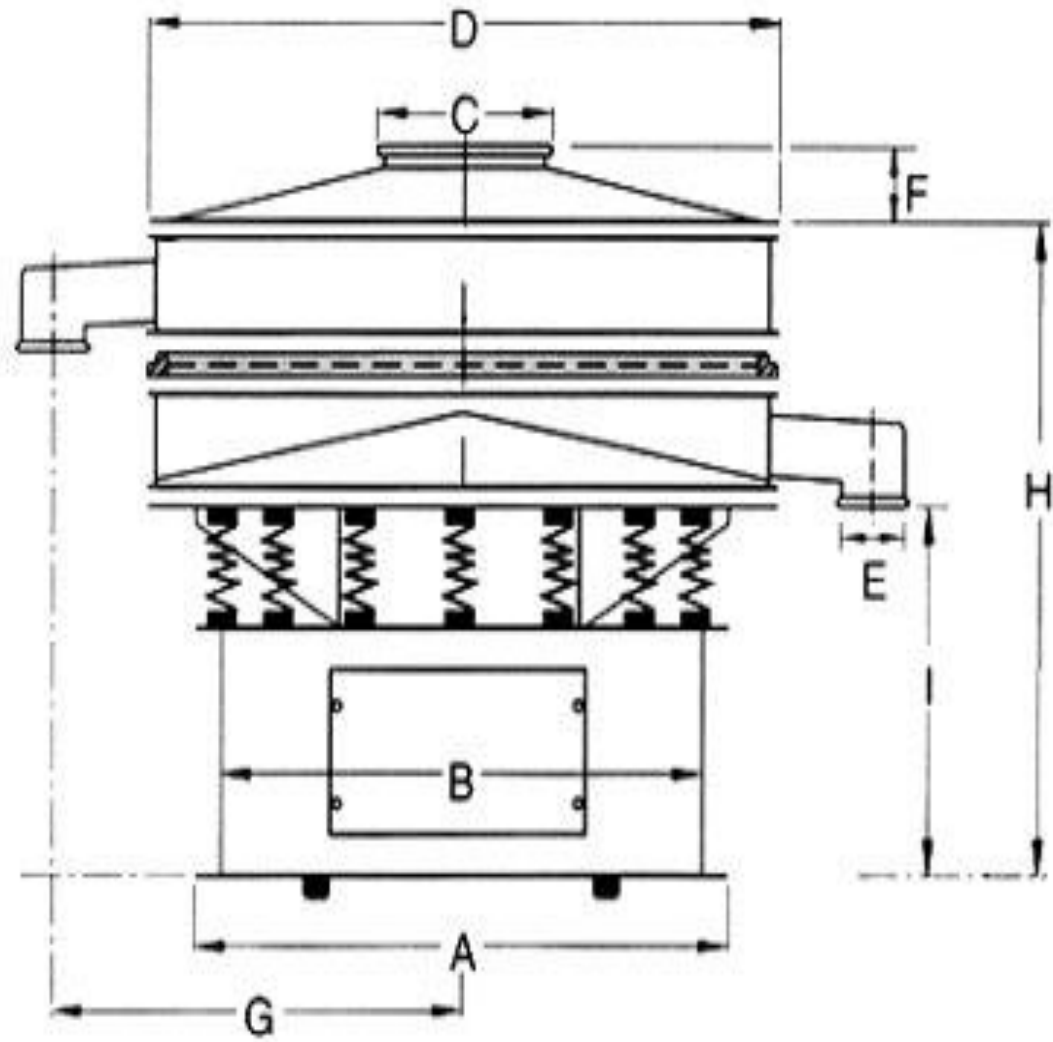

FIG-4 - 90° LEAD
Material Tends To
Stay At Center

PRINCIPLE OF VIBRO SCREEN

- THE MULTIPLANE MECHANICAL VIBRATIONS ARE OBTAINED BY SPECIAL MOTOR WITH SHAFT EXTENDED ON BOTH SIDES HAVING ECCENTRIC ADJUSTABLE WEIGHTS.
- THE MOTOR IS MOUNTED IN VERTICAL PLANE. THE COMPLETE ASSEMBLY OF SCREEN FRAMES AND MOTOR REST ON A RIGID CIRCULAR BASE THROUGH A SET OF COIL SPRINGS WHICH ALLOWS THE SYSTEM TO VIBRATE FREELY IN MULTI-DIRECTION.
- WHILE THE UPPER ECCENTRIC WEIGHT ON MOTOR IMPARTS HORIZONTAL MOTION, THE LOWER ECCENTRIC WEIGHT ADDS TO VIBRATIONS IN VERTICAL PLANE. THE NET RESULT IS HIGH SCREENING EFFICIENCY.
- THE FLOW PATTERN OF THE POWDER ON THE SCREEN SURFACE IS
- CONTROLLED BY VARYING THE POSITION OF BOTTOM ECCENTRIC WEIGHT AS EXPLAINED LATER.



MODEL	SCREEN SIZE	DISCHARGE HEIGHT			H4	H	L	O D	O d
		H1	H2	H3					
GVS-12	300	370	450	540	645	710	240	100	65
GVS-18	450	380	480	600	710	820	350	100	100
GVS-24	600	440	560	700	845	960	450	150	100
GVS-30	750	460	600	770	950	1080	560	150	150
GVS-36	900	500	660	820	980	1125	600	150	150
GVS-48	1200	550	730	930	1115	1280	800	200	200
GVS-60	1500	715	960	1245	1500	1700	985	250	200
GVS-72	1800	715	1000	1290	1625	1850	1100	300	250
GVS-84	2100	715	1015	1300	1570	1825	1230	300	250
GVS-96	2400	715	1080	1440	1750	2050	1480	250	300

VIBRO DESTONER

- THE MATERIAL TO BE PROCESSED IS FED ONTO A VIBRATING DECK OR TABLE, WHERE AN UPWARD AIRFLOW IS APPLIED. AS THE DECK VIBRATES, THE LIGHTER GRAINS OR SEEDS RISE TO THE TOP DUE TO THE AIRFLOW, WHILE THE HEAVIER IMPURITIES, SUCH AS STONES, SETTLE TO THE BOTTOM.



VIBRO MOTOR

- IT IS SIMPLE STRUCTURED SMALL SIZE VIBRATOR WITH STRONG VIBRATING FORCE. THE VIBRATOR IS RESPONSIVE FOR SUDDEN ACTIVATION DEACTIVATION WHICH ELIMINATES THE DAMAGE OF THE EQUIPMENT'S TO THE MINIMUM LEVEL.



ELECTRO-MAGNETIC VIBRATORY FEEDER

- EXCEPTIONALLY HIGH-SPEED FEEDING OF LIGHT, BULKY MATERIALS. QUICK STOPPING CHARACTERISTIC ASSURES ACCURATE HANDLING OF MATERIALS FOR ECONOMY AND EFFICIENCY IN MIXING, WEIGHING, BATCHING, PACKAGING AND BAGGING OPERATIONS. LOW-ENERGY-CONSUMING ELECTRO-PERMANENT MAGNETIC DRIVE AND AC OPERATION INCREASE PRODUCTIVITY, COST ECONOMIES AND RELIABILITY.



BIN ACTIVATOR

- BIN ACTIVATOR PLAYS AN IMPORTANT ROLE IN SOLVING MATERIAL FLOW PROBLEM CAUSED BY WEDGING, COMPACTING OR RAT HOLDING OF MATERIAL IN TAPER ZONE AT DISCHARGE END OF THE HOPPER.



OUR TRIAL AND TESTING CENTER

